

GG PUTTERS

Always a step ahead

ANTARES

CLUB TYPE BLADE PUTTER

BALANCING TOE HANG

STANDARD WEIGHTS KIT n.1 Light weight

n.2 Heavy weights

CLUBHEAD MATERIAL ALUMINUM

CLUBFACE MATERIAL STAINLESS STEEL

CLUBHEAD WEIGHT 348 g (12,27 oz)

HAND LEFT, RIGHT

GRIP MEDIUM SIZE, JUMBO SIZE

COLOR TITANIUM

SHAFT LENGHT	33"	33,5"	34"	34,5"	35"	35,5"	36"

LIE	68°	69°	70°	71°	72°

OFFSET	FULL SHAFT	HALF SHAFT	NO OFFSET

LOFT	2°	3°	4°

PUTTER COVER HANDMADE FROM GENUINE LEATHER



ORION

CLUB TYPE Mallet Putter

BALANCING Face Balanced

STANDARD WEIGHTS KIT n.1 Light weight

n.2 Heavy weights

CLUBHEAD MATERIAL ALUMINUM

CLUBFACE MATERIAL STAINLESS STEEL

CLUBHEAD WEIGHT 396 g (13,96 oz)

HAND LEFT, RIGHT

GRIP MEDIUM SIZE, JUMBO SIZE

COLOR TITANIUM

SHAFT LENGHT	33"	33,5"	34"	34,5"	35"	35,5"	36"

LIE	68°	69°	70°	71°	72°

OFFSET	FULL SHAFT	HALF SHAFT	NO OFFSET

LOFT	2°	3°	4°

PUTTER COVER HANDMADE FROM GENUINE LEATHER



BALANCE COMBINATIONS

The golfer can choose the most advantageous weighting for his specific playing style.

With the **STANDARD WEIGHT KIT** already fitted to your putter at the time of purchase, You can decide how to position the three weights at the three weight points to find the perfect arc stroke that suits your game.



If desired, additional light and heavy weights can be purchased individually to create further combinations of weight positions for the putter.

INTERCHANGEABLE FACES

The putter comes with an interchangeable face with a loft inclination of your choice (2°, 3° or 4°).
If desired, the golfer can also vary the loft by purchasing extra clubfaces.

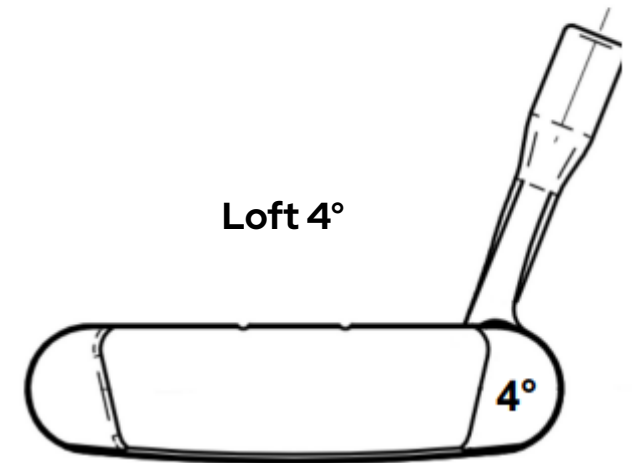
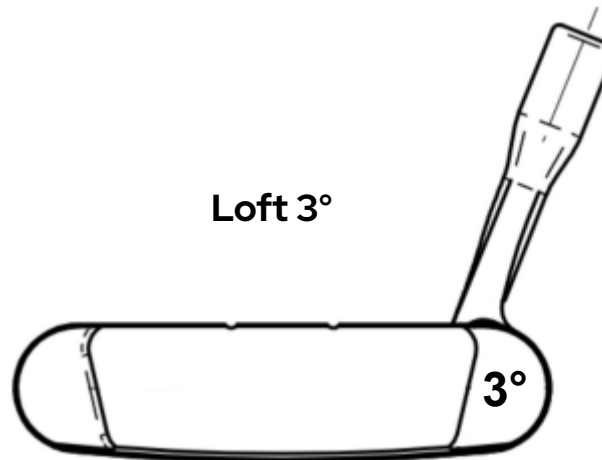
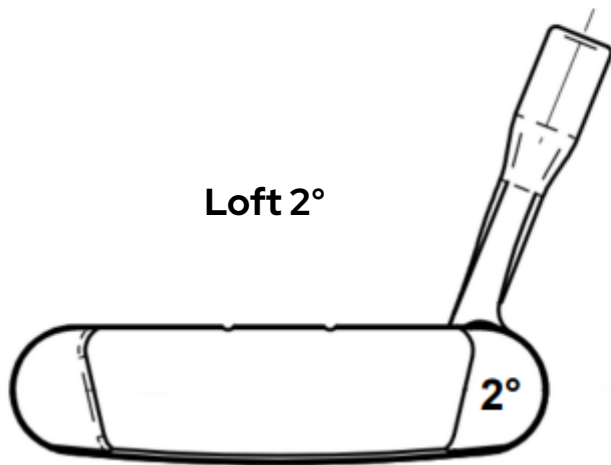
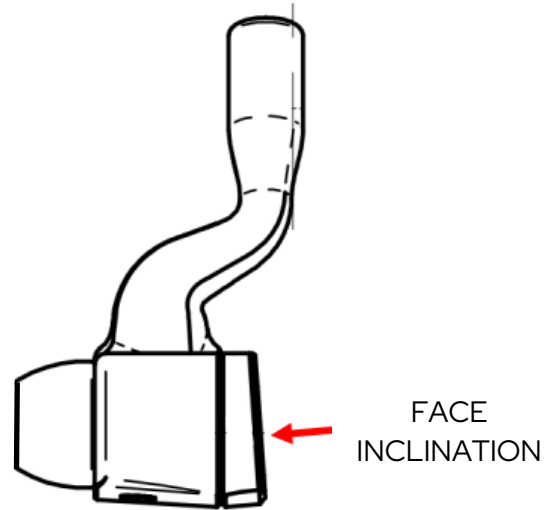

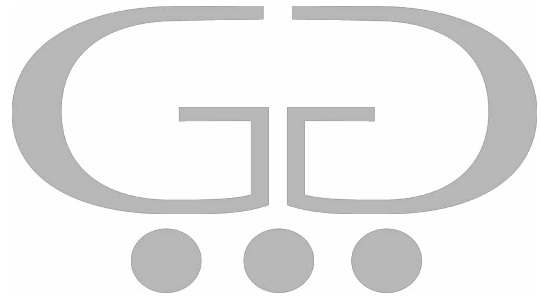

USER GUIDE

HOW TO CHANGE THE WEIGHTS

The supplied equipment must be used to modify the standard weight combination of the putter.

Use the same equipment and follow the same procedure when purchasing the extra weights.

Before proceeding to use the putter, it is necessary to make sure that every single weight has been completely closed.

We recommend following the instructions for use.

STANDARD EQUIPMENT

included with each Antares and Orion putter

- no. 1 set of weights:
1 aluminium weight and 2 stainless steel weights
(already mounted on the clubhead)
- no. 1 assembly **CLICK SYSTEM** kit,
consisting of a 3mm Allen wrench

INSTRUCTIONS FOR USE

To change the putter weights and find the combination that best suits your needs on the green, follow the procedure:

- 1) With the Allen wrench, unscrew the three grub screws on the sole of the putter until the weight comes out of its hole.
- 2) Choose your favorite weights combination.
- 3) Insert the weights into the empty spots and screw the three grub screws back in with the Allen wrench until they **click** into place.

PLEASE NOTE: After the first click, the screw is already tightened to the maximum, do not continue tightening.



HOW TO CHANGE THE

To get the best out of your putter, you can modify its club face to vary the loft angle.

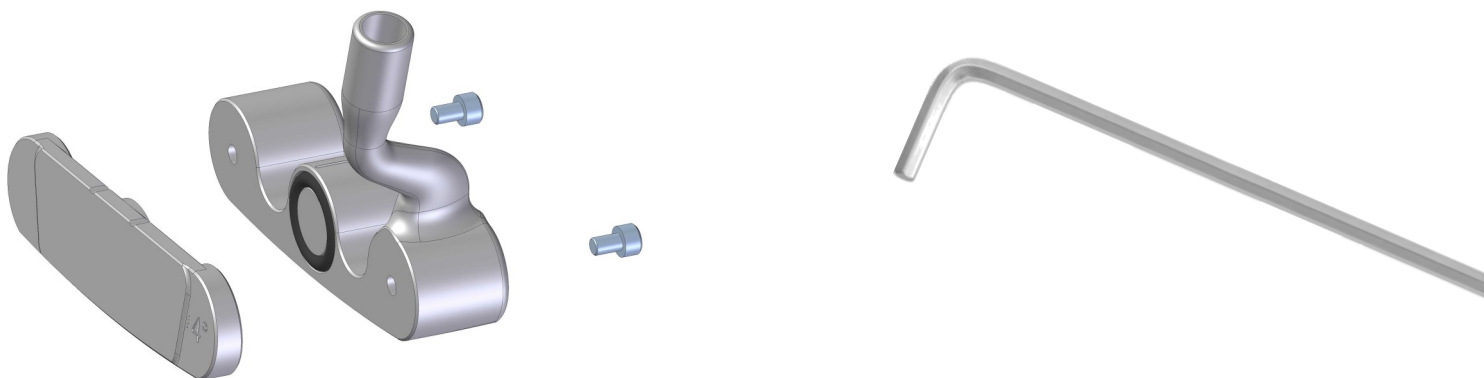

Follow the procedure:

- 1) Remove the two external weights following the “HOW TO CHANGE THE WEIGHTS” procedure
- 2) Loosen the screws with the provided Allen wrench
- 3) Change the face and tighten the screws again with the same Allen wrench until they are tightened.
You will be sure that they are screwed right when you hear the **click system sound**.

PLEASE NOTE: After the first click, the screw is already tightened to the maximum, do not continue tightening.



GG PUTTERS

Thank you for choosing our premium products,
made with the latest technology and hand
assembled by expert craftsmen.

For additional information contact us at:

info@ggputters.com

+39 331109 9739

www.ggputters.com

ORIGINAL PRODUCT



HANDMADE IN ITALY